

DISTRICT MIDMA PARCEL 0066421  
 MIDDLEFORK  
 LOCATION 2025 325\_ST

ARIES SOW, LLC

508 MARKET ST  
 AUDUBON IA 50025

CLASS AGRICULTURAL 26-67-30

A PARCEL OF LAND LOCATED IN  
 LOT 5

DEEDHOLDER ARIES SOW, LLC

EXTENDED NAME:

RECORD OF OWNERSHIP *			DATE	BK & PG	
FARIS, LYLE	TO SOUTHWEST		9-07-94	257 - 503	72024
SOUTHWEST	TO LIVESTOCK USA LC		4-22-99	271 - 783	1565,831
SWINE USA	TO WHITESTONE	#256 - 2 PARCELS AG HOG CONFINEMENT	1-16-04	307 - 36	2150,000
WHITESTONE	TO PARTNERS IN	#140 - 2 PARCELS HOG CONFINEMENT	7-10-08	331 - 856	1500,000
PARTNERS IN	TO ARIES SOW, LLC	#72 2 Parcels Hog Confinement	4-14-15	423 - 174	1500,000
LAST RECORDED DOCUMENT			DEED	04142015	423 - 174

LAND VALUE COMPUTATIONS								YR	ITEM	ASSESSED VALUE
ACTUAL FRONT	AVG DEPTH	UNIT PRICE	DEPTH FACTOR	FRONT FT VAL	TOTAL	ADJ	ACTUAL VALUE			
						/		14	LAND	14,470
									DWLG	94,330
									IMPR	551,770
									TOT	660570

ABATED AMT  
38959

STREET		UTILITIES	
		WATER	
		SEWER	

front fig							
ACTUA						ACRES	
L REAR							



<b>ACRES:</b>	GROSS ACRES	19.45
	NET ACRES	19.45
<b>EXEMPTIONS:</b>	AGPC	<b>ACRES</b> 0 <b>VALUE</b> 38959
	CSR	0

**NOTES:**

15	LAND	11,585
	DWLG	94,330
	IMPR	587,872
	TOT	693787 **
	LAND	
	DWLG	
	IMPR	
	TOT	
	LAND	
	DWLG	
	IMPR	
	TOT	
	LAND	
	DWLG	
	IMPR	
	TOT	

DISCLAIMERS:

\* MAY NOT BE ALL THE SALES FOR THIS PROPERTY

\*\* MAY NOT BE FINAL ASSESSMENT VALUE FOR CURRENT YEAR

PARCEL 0066421

LOCATION 2025 325\_ST

DISTRICT MIDMA

OCCUPANCY SINGLE  
 FOUNDATION CONCRETE  
 BASEMENT AREA FULL  
 EXTERIOR WALL VINYL SIDING  
 ROOF INSUL YES  
 BLANKET INS YES  
 ROOF TYPE HIP  
 ROOF COVER ASPHALT

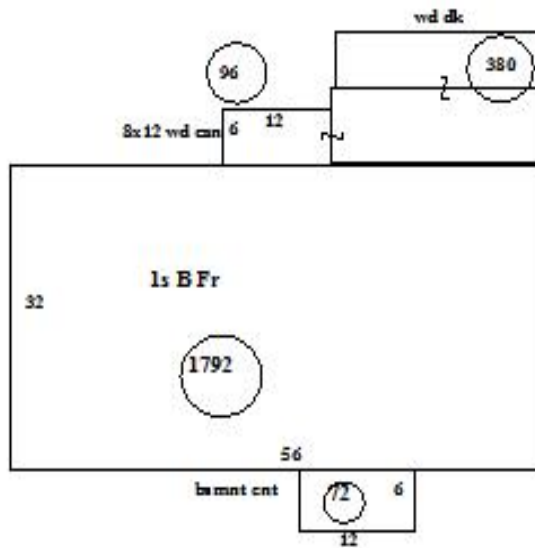

YEAR BLT 1990  
 CONDITION AN  
 GRADE 4+5  
 YR REMODEL

	CONST	STORY	AREA
MAIN HOUSE	FR	IS	1792
ADD 1			
ADD 2			
ADD 3			
ADD 4			
ADD 5			
ADD 6			
ADD 7			
OTHER	WOOD ROOF	480	96
OTHER	FR BSMT ENT	1368	72
OTHER	WD DK 12.00	4560	380
ATT			
GAR			
DET		VALUE	0
GAR		OBSOL	
AREA		OVRRD VAL	
GRD		OTHER VAL	
YR			

**#2 HOG CONFIN COMPLEX 82,632 SQ FT, #3 7 BULK BINS**

	B	1	2	3	A
TOTAL RMS		5			
BEDRMS		2			

BASEMENT FINISH  
 SQ FT BSMT FIN  
 TYPE BASE FIN  
 APARTMENT  
 I\_LAUNDRY\_RM  
 REC RM  
 GARAGE  
 BSMNT ADD  
 BASE FINI VAL

AIR CONDITION YES  
 I\_HEATING FORCED AIR  
 FUEL TYPE GAS LP  
 NO HEAT  
 HEAT ALT  
 FIREPLACE  
 I\_ATTIC

PLUMBING		KITCHEN	
BATHROOM	1	BI RANGE	
SH STALL BATH		BI OVEN	
SH STALL EXT		BI DW	1
I_TOILET_RM		BI BBQ	
LAV EXTRA		BI MICRO	
H2O CLOSET	1		
I_SINK_EXTRA			
WHPOOL TUB			
I_HOT TUB			
I_SAUNA			

FINAL HOUSE VAL	85760
LAND VALUE	<Table
LAND + DWLG	

**ALL VALUES ARE SUBJECT TO CHANGE**

RINGGOLD COUNTY ASSESSOR  
 109 W MADISON  
 MOUNT AYR IA 50854

LEN WIDTH HEIGHT CONSTRUCTION AREA  
 X  
 YEAR BLT M S AGE OBSOLE M S CONDITION  
 FLR

	blgd use	construction type	width	length	diameter	height	area	year blt	cond
1	Shed	Pole Frame	20	22		440	yes		G
2	Hog unit	Fr	60	488			29280	1995	
3	Bulk bins	<u>?</u> 2				6t	questi	1995	\$1,017
4	Hog unit	Fr	60	355			21300	1995	\$160,929
5	Hog unit	Fr	70	378			26460	1995	\$200,696
6	Hog unit	Fr	41	112			4590	1995	\$29,704
7	walkways	Fr	4	250		1000	Insert	1995	\$2,473
8	Bulk bins	<u>?</u> 5				10t	questi	1995	\$3,318
9	tank	Steel		18000		0	Insert	1995	\$9,265
10									
11									
12									
13									
14									
15									
16									
17									
18									
19	notes								
20									

BLDG CT  
<Tabl

AGP

CLASS A

CLASS A  
BLDG VAL  
\$587872

04/20/2015

DISTRICT MIDMA PARCEL 0069201  
 MIDDLEFORK  
 LOCATION 27-67-30

ARIES SOW, LLC

508 MARKET ST  
 AUDUBON IA 50025

CLASS AGRICULTURAL 27-67-30

A PARCEL OF LAND LOCATED IN  
 LOT 8

DEEDHOLDER ARIES SOW, LLC

EXTENDED NAME:

RECORD OF OWNERSHIP *		DATE	BK & PG	
FARIS, LYLE	TO SOUTHWEST	9-07-94	257 - 503	7976
SOUTHWEST	TO LIVESTOCK USA LC	4-22-99	271 - 783	579143
LAST RECORDED DOCUMENT		DEED	04142015	423 - 174

LAND VALUE COMPUTATIONS								YR	ITEM	ASSESSED VALUE	
ACTUAL FRONT	AVG DEPTH	UNIT PRICE	DEPTH FACTOR	FRONT FT VAL	TOTAL	ADJ	ACTUAL VALUE				
						/		14	LAND	5,610	
									DWLG	0	
									IMPR	75,020	
									TOT	80630	
								15	LAND	4,892	
									DWLG	0	
									IMPR	79,909	
									TOT	84801	**
									LAND		
									DWLG		
									IMPR		
									TOT		
									LAND		
									DWLG		
									IMPR		
									TOT		
									LAND		
									DWLG		
									IMPR		
									TOT		

ABATED AMT  
0

STREET		UTILITIES	
		WATER	
		SEWER	

ACRES: GROSS ACRES 6.00  
 NET ACRES 5.68  
 EXEMPTIONS: ACRES 0 VALUE 0  
 CSR 0

NOTES:

DISCLAIMERS:

\* MAY NOT BE ALL THE SALES FOR THIS PROPERTY      \*\* MAY NOT BE FINAL ASSESSMENT VALUE FOR CURRENT YEAR

PARCEL 0069201

LOCATION 27-67-30

DISTRICT MIDMA

OCCUPANCY  
FOUNDATION  
BASEMENT AREA  
EXTERIOR WALL  
ROOF INSUL  
BLANKET INS  
ROOF TYPE  
ROOF COVER

--	--	--	--	--	--

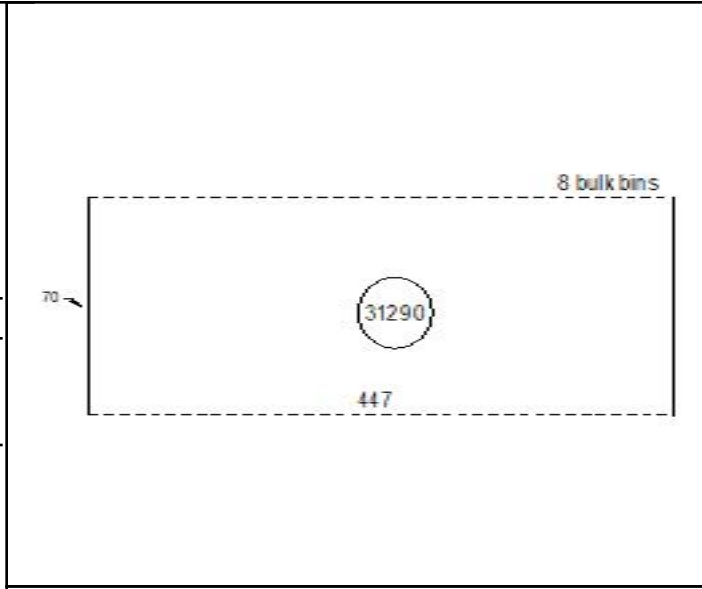

YEAR BLT    CONDITION    GRADE    YR REMODEL

--	--	--	--

TOTAL RMS  
BEDRMS

B	1	2	3	A

BASEMENT FINISH  
SQ FT BSMT FIN  
TYPE BASE FIN  
APARTMENT  
I\_LAUNDRY\_RM  
REC RM  
GARAGE  
BSMNT ADD  
BASE FINI VAL

--

**#1 HOG CONF COMPLEX 31,290 SQ FT, #2 8 BULK BINS**

AIR CONDITION  
I\_HEATING  
FUEL TYPE  
NO HEAT  
HEAT ALT  
FIREPLACE  
I\_ATTIC

--

BATHROOM  
SH STALL BATH  
SH STALLL EXT  
I\_TOILET\_RM  
LAV EXTRA  
H2O CLOSET  
I\_SINK\_EXTRA  
WHPOOL TUB  
I\_HOT TUB  
I\_SAUNA

BI RANGE  
BI OVEN  
BI DW  
BI BBQ  
BI MICRO

PLUMBING

KITCHEN

	CONST	STORY	AREA
MAIN HOUSE			
ADD 1			
ADD 2			
ADD 3			
ADD 4			
ADD 5			
ADD 6			
ADD 7			
OTHER			
OTHER			
OTHER			
ATT			
GAR			
DET			
GAR		VALUE	0
AREA		OBSOL	
GRD		OVRRD VAL	
YR		OTHER VAL	

FINAL HOUSE VAL    0

LAND VALUE    <Table

LAND + DWLG

**ALL VALUES ARE SUBJECT TO CHANGE**

RINGGOLD COUNTY ASSESSOR  
109 W MADISON  
MOUNT AYR IA 50854

LEN    WIDTH    HEIGHT    CONSTRUCTION    AREA  
          X  
YEAR BLT    M S AGE    OBSOLE    M S CONDITION  
  
FLR

	<b>blgd use</b>	<b>construction type</b>	<b>width</b>	<b>length</b>	<b>diameter</b>	<b>height</b>	<b>area</b>	<b>year blt</b>	<b>cond</b>	
1	Hog unit	Fr	70	447			31290	1995	N	\$79,909
2	Bulk bins	Steel						1995	N	\$0
3										
4										
5										
6										
7										
8										
9										
10										
11										
12										
13										
14										
15										
16										
17										
18										
19	<b>notes</b>									
20										

BLDG  
CT  
<Tabl

CLASS  
A

CLASS  
A  
BLDG VAL  
\$79909

04/20/2015